



## W1200 SERIES PRESSURE FILTERS WITH ΔP INDICATOR OPTION

Flows Up To: 120 GPM (454 L/MIN)

Port Sizes: 1 1/4" & 1 1/2" NPTF

1 5/8"-12UN (SAE-20)

1 7/8"-12UN (SAE-24)

Max. Operating Pressure: 1,200 PSI (83 BAR)

Application: Inline Filtration

High Shock Return Line Filtration

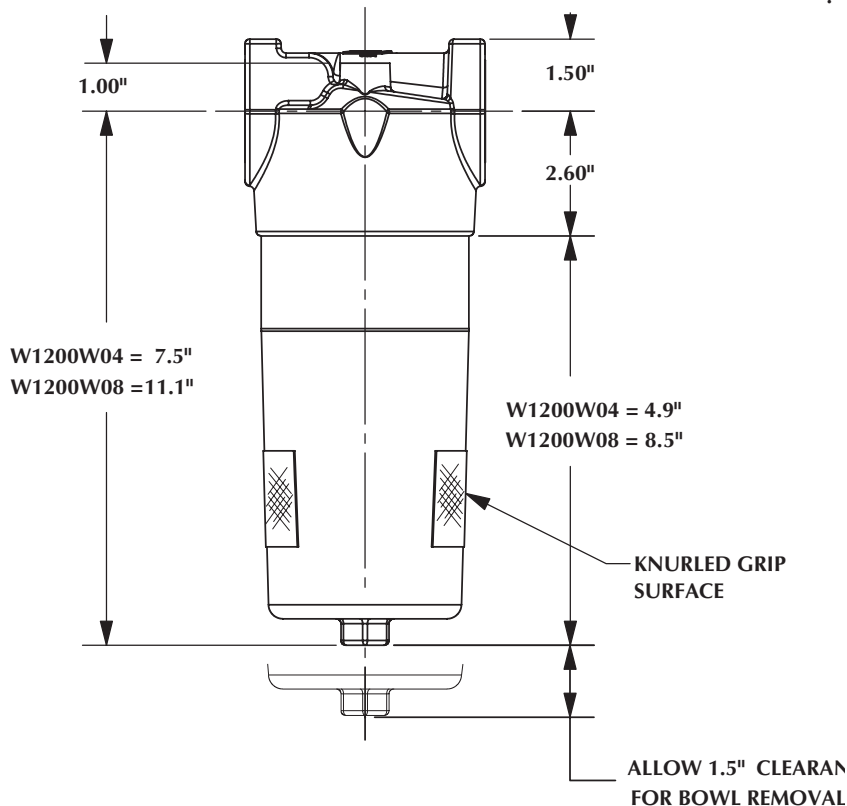
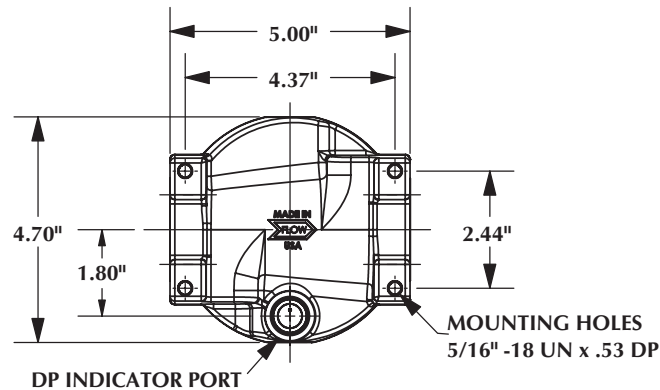

### SPECIFICATIONS

Code Number	Removal Rating B <sub>x</sub> > 200
03H	2
03L	3
06L	6
10L	12
10H	15
20L	25

#### REFERENCE

Beta<sub>x</sub> Rating of 200=99.5% Efficiency

#### PRESSURE RATING

**Maximum Operating:** 1,200 PSI (83 Bar)

**Burst Pressure:** 3,000 PSI (206 Bar)

**Rated Fatigue Pressure:**

0-1000-0 PSI for 1,000,000 Cycles  
Per NFPA T2.6.1 R2-2000

#### TEMPERATURE RANGE

**Operating:** -40° F to +250° F  
(-4° to +120° C)

#### BY-PASS SETTING OPTION:

No By-Pass or 50 PSID

#### ΔP INDICATOR OPTIONS

Visual, Single Wire DC Electrical, or  
Electrical/Visual w/ DIN Connector

#### FLUID COMPATIBILITY

**Elements:** Suitable For Use with  
Petroleum Base Fluids. Consult  
Factory For Use With Other Fluids.

#### MATERIALS

**Head:** Die Cast Aluminum

**Bowl:** Anodized Die Cast Aluminum

**By-Pass:** Nylon

**Element Hardware:** Plated Carbon  
Steel End Caps and Core. Epoxy  
Endcap Adhesive.

**Filter Media:** Z-Glass Fiber Standard

#### WEIGHT

**P3000G04:** 6.6 lbs. (3 Kg)

**P3000G08:** 8.8 lbs. (4 Kg)

# W1200 Pressure Drop Curves

Fluid Viscosity 150 SUS at 105°F (34 CS at 40°C)

4" Length

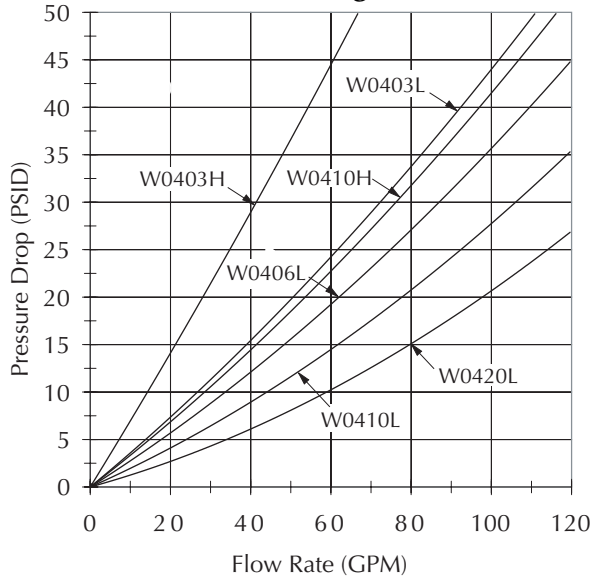

8" Length

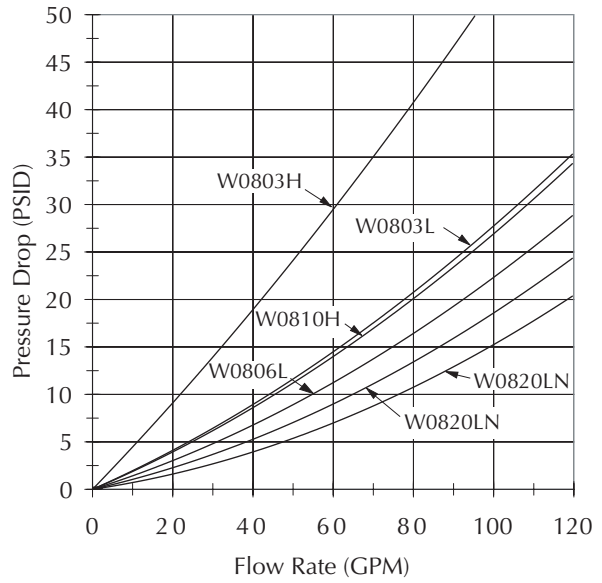

PRESSURE FILTERS

**HOW TO ORDER:** W1200 XXX XX X XX XX X - W XX XXX X

Code	Maximum Pressure
W1200	1,200 PSI (83 BAR)

Code	Port
N20	1 1/4" NPTF
N24	1 1/2" NPTF
S20	1 5/8" - 12UN (SAE-20)
S24	1 7/8" - 12UN (SAE-24)

Code	Nominal Bowl Length
04	4 Inches (100 mm)
08	8 Inches (200 mm)

Code	ΔP Indicator Type	Indicator Series
0	No Indicator	None
V	Visual	DP04
D	DC Electrical Single Wire	DP06
H	Vis/Elec w/DIN Connector	DP05

Code	ΔP Indicator Setting
00	No Indicator
44	44 PSID

Code	By-Pass
00	No By Pass *
50	50 PSID (3.4 BAR)
* Proper Element Selection Required	

Code	Element Seal Material
N	Buna "N"
V	Fluorocarbon

Filter Element Options	
Code	Micron-Media-Collapse
03L	3 Micron, Z-GLASS, 150 PSID (20.7 BAR)
03H	3 Micron, Z-GLASS, 3,000 PSID (207 BAR)
06L	6 Micron, Z-GLASS, 150 PSID (20.7 BAR)
10L	10 Micron, Z-GLASS, 150 PSID (20.7 BAR)
10H	10 Micron, Z-GLASS, 3,000 PSID (207 BAR)
20L	20 Micron, Z-GLASS, 150 PSID (20.7 BAR)

Code	Nominal Filter Element Length
04	4 Inches (100 mm)
08	8 Inches (200 mm)

Element Series	
"W" Series	

Code	Housing Seal Material
N	Buna "N"
V	Fluorocarbon